

B1-B11	13.32	193.5	+27	-	13.32	0	0	X
B1-B12	21.93	003	+5	-	3.0	2.0	X	
B1-B13	11.64	021	-10	-	0	2.0	X	
B1-B2	14.70	153.5	+3	-	2.0	0	1.7	✓
B2-B21	17.52	070.5	-13.5	2.0	3.5	0	1.5	✓
B2-B22	23.94	124	-10	0	-	0	2.0	✓
B3-B22	21.13	049	+1	1.8	-	2.0	0.5	✓ Sta
B3-B31	16.97	101	+10.5	0	-	2.5	1.5	✓
B3-B32	14.65	149	0	-	1	0	2.0	✓
B3-B4	22.49	160.5	-3.5	-	-	7.0	1.5	✓
B4-B41	7.40	030	+7.5	2.5	0	7.0	2.5	✓
B4-B42	14.60	123	0	0	-	3.0	1.6	✓
B4-B43	27.03	175.5	-5	-	0.5	2.0	2.0	✓
B4-B44	11.50	214	-1	-	-	1.5	1.7	✓

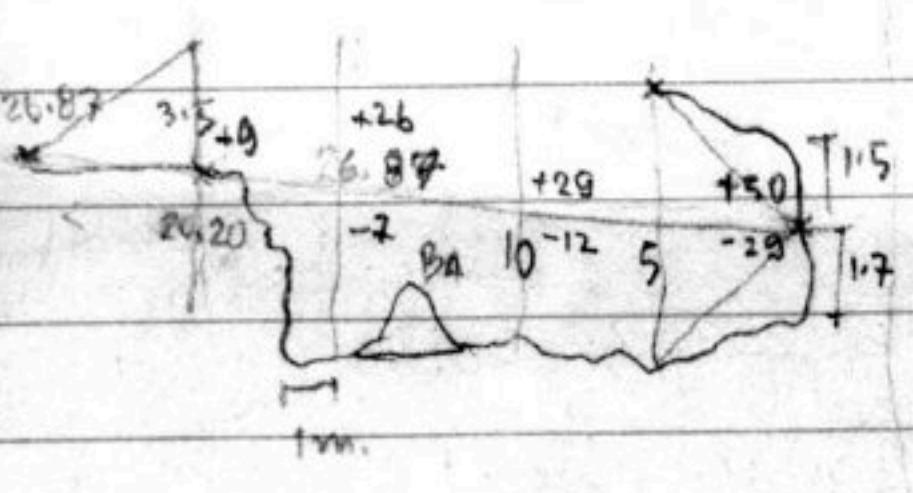

мониторинг

B43-B51	12.86	054.5	+3	-	3.0	2.5	2.2	✓ F+3
B43-B52	9.10	124	0	-	1.3	4.0	1.7	✓ F+1
B43-B53	13.89	225	-2	-	0	1.5	1.7	✓
B43-B5	24.13	149.5	-4.5	2.0	-	3.0	0.3	✓
B5-B54	14.95	309	+15	-	-	0	2.5	✓
B5-B55	20.40	247	+20.5	5.0	2.0	3.0	1.8	✓
B5-B56	16.10	244	0	0	3.5	0	0.5	✓ F+4
B5-B57	8.93	198	+1.5	0	0	1.2	0.5	✓
B5-B6	15.20	191	-3.5	6.25	4.5	12	0.3	X
B6-B7	24.93	104.5	+0.5	5.76	7.64	2.3	0.3	X R+1.5
B7-B8	16.37	160	-1.5	11.04	8.27	2.5	0.3	X
B8-B9	26.30	202	0	8.10	13.95	3.5	0.5	X
B9-B10	26.95	199.5	-1	14.50	0	0	1.8	✓ central +3.0
B10-B11	27.27	132	-2.5	4.65	14.22	2.5	0.3	20 m diameter
B11-B11/4	13.30	007.5	+4.0	3.0	0	0.5	1.0	
B11-B11/2	14.32	195.5	+3.5	E	0	0.5	1.5	diameter 6 m.
B11-B11/3	14.13	142	+12	3.5	E	0.5	1.7	

мониторинг

C1-C11	30.03	320	+24.5	4.0	7.0	8.0	8.0	✓ F+5 m. (Entrance)
C1-C12	25.45	044.5	+4.0	2.5	2.0	10	1.5	✓
C1-C13	16.11	170	-8.0	-	-	-	-	✓
C1-C14	34.6	040	0	0	7.87	10	0	✓ (7) m dia
C1-C15	20.6	102.5	+13	0	-	30	1.5	✓
C1-C16	11.70	072	+29	0	E	30	1.5	✓ (15) Tree 150' (ent)
C1-C17	12.30	142.5	+30	1.0	0	-	1.5	✓
C1-C18	12.95	141.5	-20	-	-	-	-	✓ C17-Tree 145'
C2-C1	12.21	359	+11.5	-	-	-	-	✓
C2-C3	14.50	240	-15	-	2.0	-	0.3	✓
C3-C4	21.65	255.5	-5	-	-	50	1.0	✓
C4-C5	22.95	232.5	+6	-	-	50	1.0	✓
C4-C6	14.70	162.5	-6.5	-	0.5	15	0.5	✓ OFFSET 5.3 R m dia
C6-C7	24.45	081.5	+2.5	5.0	0	10	3.0	✓
C7-C8	22.40	081.5	-4.5	5.0	4.0	50	2.5	✓
C8-C9	20.10	080	-10	-	-	-	-	✓

DATA

мониторинг

to from.								
B2 D1	7.47	177.5	-6	4.0	2.0	0	2.0	B2
D1-D2	10.30	141	+5	4.5	0.5	1.2	1.5	D1
D2	-	-	-	3.5	2.5	18.0	1.8	D2
D1-D3	11.75	191	+21	2.0	3.0	20.0	0	D3
D3-D4	7.36	240	+18	1.5	0	0	1.0	D4
D4-D5	2.83	152.5	+28	1.5	0	0	1.0	D5-D4
D4-D6	9.94	222.5	+17.5	1.0	0.5	15.0	0	D5
D6	-	-	-	-	0.5	2.0	1.5	D6
D6-D7	12.49	105	-14	1.0	0	1.5	1.6	D6
D7-D8	11.25	019	-6	-	3.5	15	1.8	D7
D8	-	-	-	1.0	3.5	20	0	D8

мониторинг

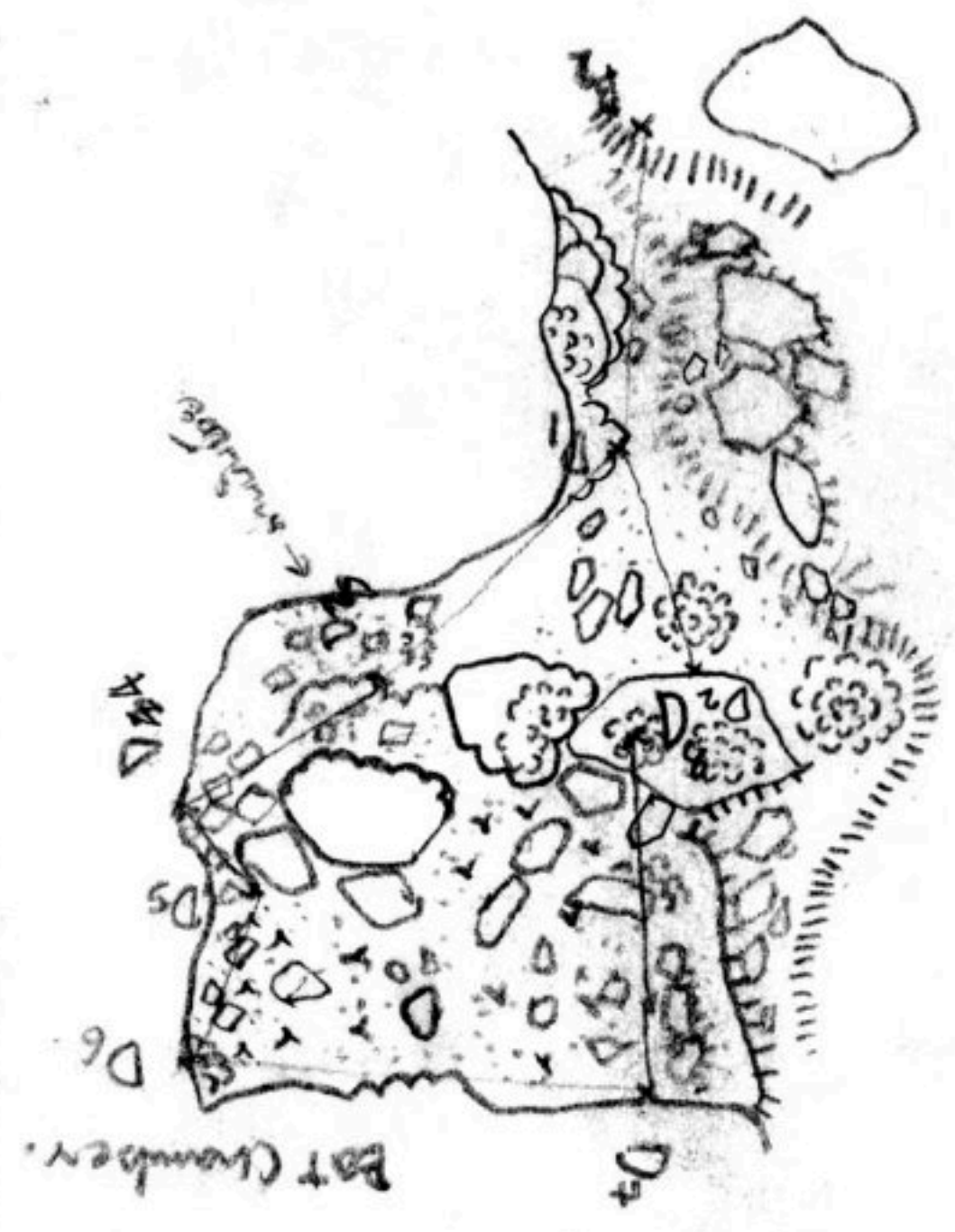

มณฑลอุดร

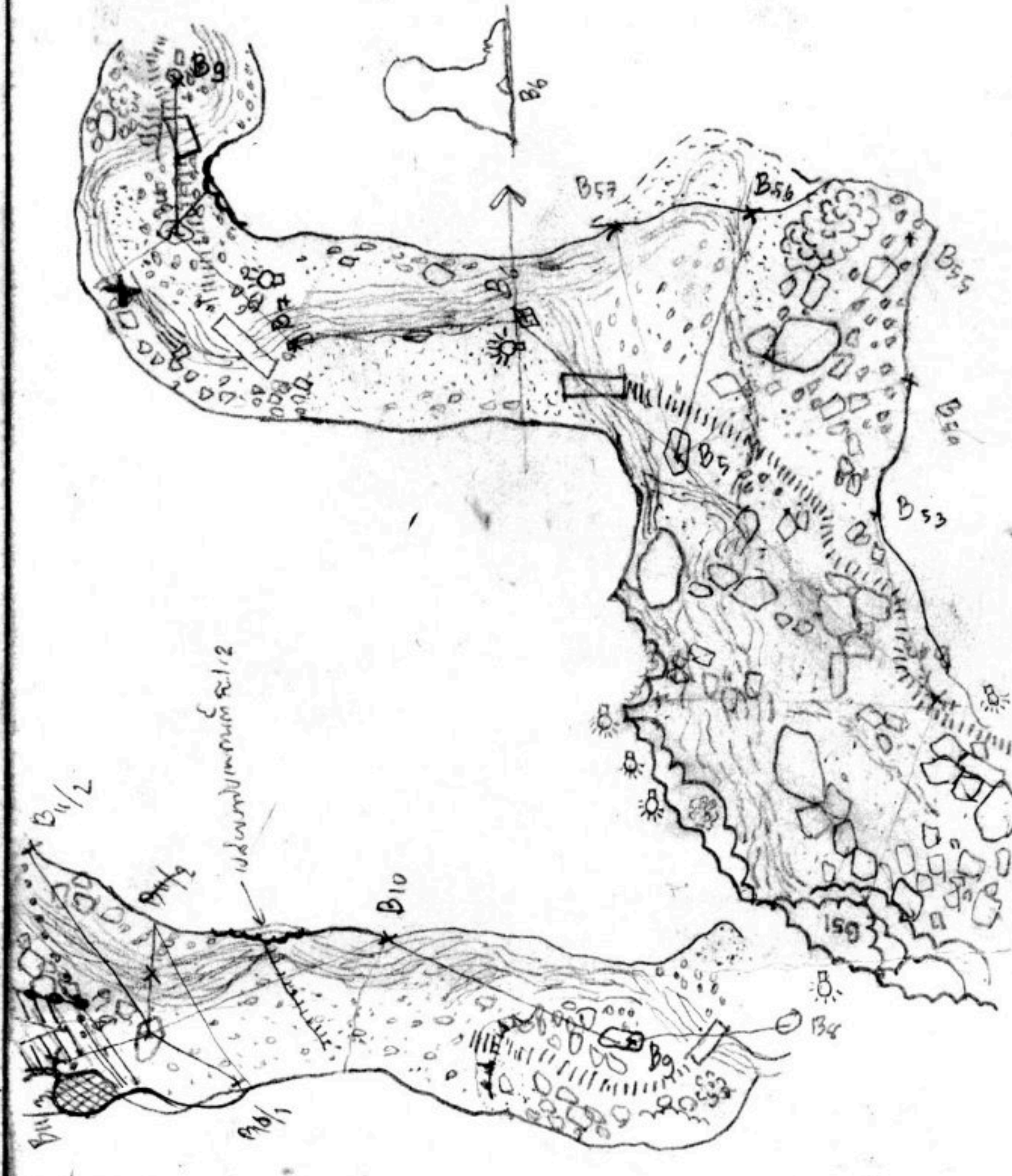

มณฑลอุดร

Cave map (CML) ✓

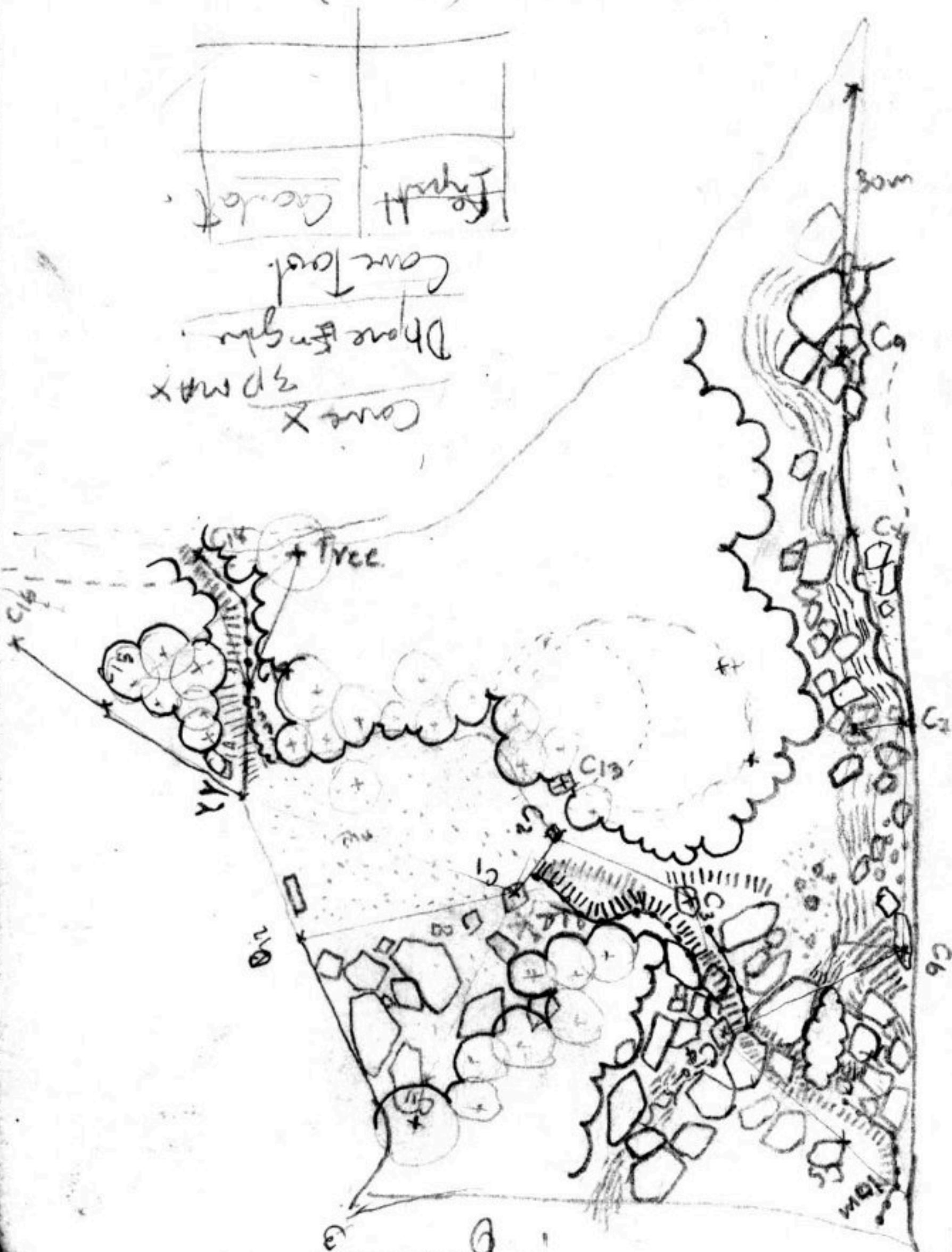

มณฑลอุดร

